

# Installation Manual

Model: HD-468

Thank you for choosing our antenna, please follow the steps to connect the antenna:



1. Connect the power adaptor to the antenna DC input.

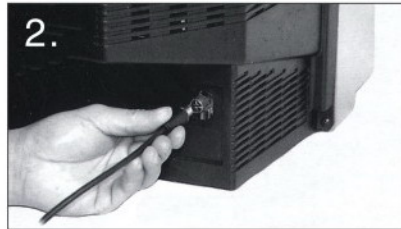

2. Connect the antenna output to your TV or converter box input using the coaxial cable included.



3. Turn on the antenna and adjust the output gain level.

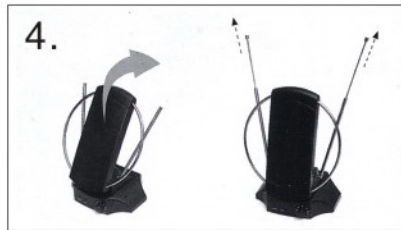

4. Pull the rod antenna out at its longest length, adjust to the best reception angle.



## What you need to know after you connect your Antenna?

After you connect your Antenna to the TV, refer to your TV instruction on how to set up the single source to Air/Antenna type and scan the digital channels.

If you are using a digital converter box, please refer to the instruction for the converter box to scan the channels.

For most of the HDTV today, you will need to set up the signal source correctly in order to get the digital channels.

You can go to your TV menu and find the setting or installation option. Set up the signal source to AIR/Antenna.

After you set up the signal source, go to Channel scan or Channel manage to scan the digital channels. This process will usually take 5-10 minutes to finish. You will be able to see the Channels count during the scan process.

For technical support please contact your seller or

LAVA Electronics Inc.  
2580 E Philadelphia St. STE E  
Ontario, CA 91761  
Tel: 909-923-8743  
E-mail: [support@lavasat.com](mailto:support@lavasat.com)